

Statement

Please read this manual carefully before using and strictly operate and store it in accordance with the instructions. Please save the manual for your future reference. If you need further assistance than the user manual, please consult your retailer for help or email us: info@saramonic.com

General Introduction

The Saramonic SR-BH700 are professional over-ear headphones for accurate audio monitoring. High-resolution sonic performance allows the creative intention to be revealed in the detailed sound. High-fidelity audio output reproduces each sound element exactly as it is. These realize natural and rich sound reproduction without coloring, making SR-BH700 ideal for mixing and music production. Featuring 800mW maximum input power, the SR-BH700 is better compatible with high-power equipment and excels in studio recording, audio editing and other scenarios.

Each of these qualities retains and reproduces accurate and detailed sound, ensuring that the sound is free of distortion. The SR-BH700 provides an almost-revelatory sonic performance for music creators and delivers an ideal listening experience for audiophiles.

Features

Accurate Sound Reproduction

- 50mm large-aperture drivers with titanium-plated metal composite diaphragm and carefully tuned sound damping for high-quality sound reproduction
- A frequency response of 20Hz to 28kHz for reproducing rich bass and super high
- Equipped with a professional HiFi audio cable: It is braided by 16-core monocrystalline copper which is wear-resistant, soft and tough. The HiFi audio cable can transmit high-fidelity sound from the extended high-end to the lowest audible ranges of bass without signal interference, retaining rich and natural details. It features a Teflon™ shield with good insulation, low capacitance resistance, and a smaller friction coefficient.

All-Day Comfortable Fit

- The bottom of the headphones features a 3.5mm locking connector to fit stably
- Comfortable earcups with skin-friendly detachable earpads (covered by protein leather or suede material) and memory foam cushions for excellent sound isolation

Universal Compatibility

- The headphones have an impedance of 32 ohms, which is efficiently driven by mobile phones, tablets and other low-power devices
- Equipped with detachable cables (includes 3.5mm coiled cable, 3.5mm HiFi cable and 1/4" adapter)

Durable Structure

- Over-ear, closed-back design offers excellent sound-isolation
- Carefully crafted using metal cantilever and earcup panels for lasting durability
- 90° swiveling earcups for space-saving transport

How to Use

1. Connect your headphones to your device with the included audio cable. Lock the plug that connects to the headphone port.

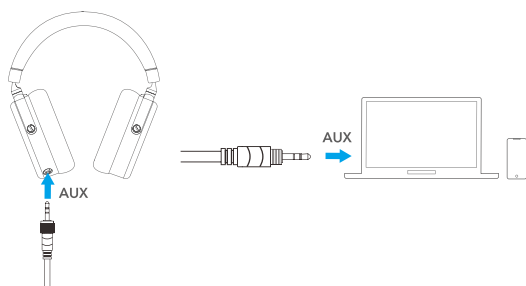

2. Adjust your headphones as shown in the picture to get a better fit.

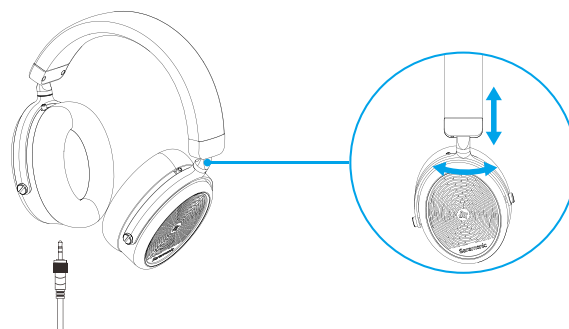

HINT:

1. If your device features a 6.35mm audio port, the included 6.35mm screw-on audio adapter can be used to connect it.

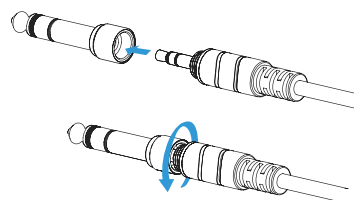

2. The SR-BH700 headphones can be used with SR-MC11 Inline remote & microphone cord (sold separately).

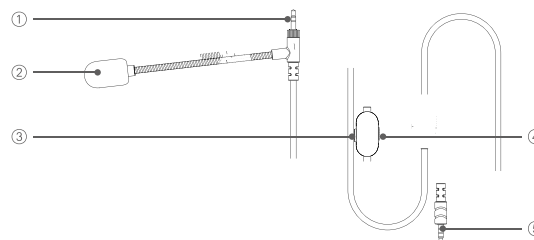

- ① 3.5mm locking-type audio connector (for headphones)
- ② Microphone
- ③ Mute control for microphone
- ④ Monitoring volume control (slide and hold to adjust quickly)
- ⑤ 3.5mm audio connector (for device)

In the Box

- SR-BH700 Headphones
- 3.5mm Locking-Type Coiled Audio Cable (3.3 to 9.8')
- 3.5mm Locking-Type HiFi Audio Cable (3.9')
- 3.5mm to 6.35mm (1/4") Screw-On Audio Adapter
- A Pair of Protein Leather Earpads
- Carrying Pouch

Specifications

Headphones

Driver Diameter	Φ 50mm
Frequency Response	20 Hz-28 kHz
Sensitivity	98 dB/mW
Impedance	32 ohms
Maximum Input Power	800 mW
Audio Input	3.5 mm jack with a twist-to-lock system
Dimensions	214.5 mm×178.3 mm×91.6 mm
Weight	Approx. 373 g

HiFi Audio Cable

Shield	Heat-resistant Teflon™ shield
Material	Monocrystalline copper
Dimensions	Eight 16-core silver-plated copper braided wire
Cable Length	1.2 m (3.9')

声明

请在使用前仔细阅读本手册，并严格按照说明进行操作和存储。请妥善保管好说明书以供将来参考。如果用户手册不能帮助您解决某些问题，请向零售商寻求帮助或给我们发送电子邮件：info@saramonic.com

概述

SR-BH700 是一款封闭式专业录音监听耳机，为混音和母带制作的创作者而生。其高解析力让创作意图在细节中流露，高保真音频输出让音频原汁原味呈现，无过多音染。最大输入功率达 800mW，能更好的兼容大功率设备，适用录音、后期制作等场景，确保录音音频不失真，真实还原每个细节。SR-BH700 助力音乐创作者的同时，也同样适合音乐发烧友聆听，感受真实之美。

特点

原声全面精准再现

- 50mm 大尺寸发声单元，金属镀钛的复合膜片与精心调谐的声学阻尼，高度还原三频细节。
- 20-28000Hz 超宽频响应，同时复现丰富低频与超高频声音信号。
- 配有专业 HiFi 音频线：它由 16 芯单晶铜立体编织，且材质耐磨、柔软坚韧；能传输高保真音质，高中低频率层次分明，免去信号传输干扰，保留丰富自然的细节；具有特氟龙屏蔽层，绝缘性强，电容阻值低，摩擦力系数小。

佩戴体验舒适贴合

- 耳机底部带有外螺纹锁紧结构，稳固贴合佩戴。
- 耳套亲肤柔软，支持拆卸更换（蛋白皮 / 冷凝硅胶绒布）；内置惰性海绵，隔绝外部噪音。

使用设备广泛兼容

- 32Ω 阻抗，轻松驱动手机，平板等小功率设备。
- 配置 3.5mm HiFi 音频线，3.5mm 弹弓音频线，6.35mm 音频转接头，可根据需求自由更换使用。

结构设计实际耐用

- 包耳封闭式设计，减少漏音，增强隔音性能
- 金属悬臂 & 耳罩面板，坚固耐用
- 耳罩平叠式设计 便于收纳

操作图示

1. 使用随附的音频线，一端插入耳机并锁紧，另一端连接至您设备的音频接口；

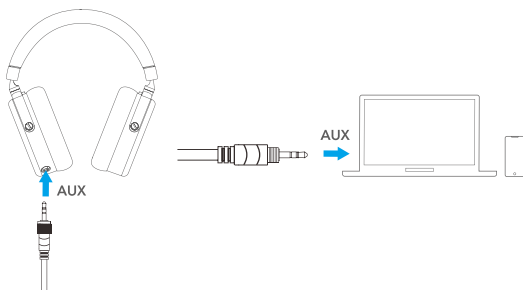

2. 按下图所示，将耳机调整至舒适位置即可佩戴使用。

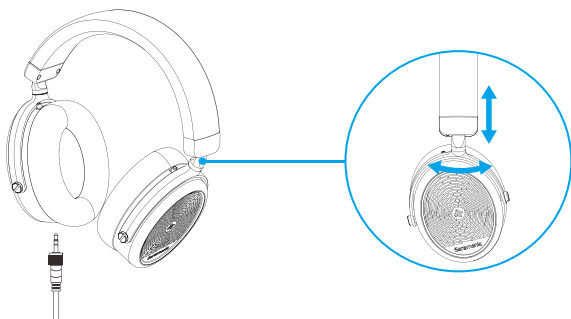

提示：

1. 若您设备的是 6.35mm 音频接口，可使用随附的 6.35mm 自锁式音频转接头连接。

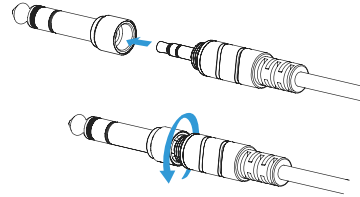

2. 可搭配 SR-MC11 耳麦控线使用（另售）。

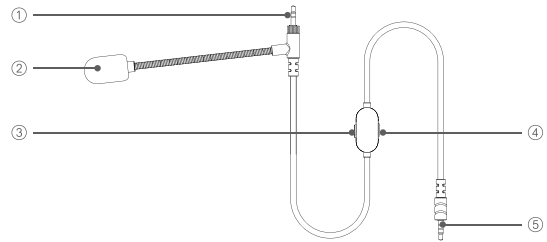

- ① 3.5mm 自锁式音频插头（耳机端）
- ② 麦克风
- ③ 麦克风静音开关
- ④ 监听音量调节开关（长按可快速调节）
- ⑤ 3.5mm 音频插头（设备端）

包装清单

- SR-BH700 耳机（黑色）
- 3.5mm 自锁式弹弓音频线（1 米 ~3 米）
- 3.5mm 自锁式 HiFi 音频线（1.2 米）
- 3.5mm 转 6.35mm 自锁式音频转接头
- 蛋白皮耳套（一对）
- 收纳袋

参数

耳机

喇叭规格	Φ50mm
频率范围	20Hz-28kHz
灵敏度	98dB/mW
阻抗	32Ω
最大输入功率	800mW
音频接口	3.5mm 插孔（带锁紧结构）
尺寸	214.5mm × 178.3mm × 91.6mm
重量	约 373g

HiFi 音频线

外被	特氟龙耐高温材质
材质	单晶铜
尺寸	八股 16 芯银铜编织线
线长	1.2 米