

NUX

B-3RC
WIRELESS SYSTEM



© Cherub Technology Co., Ltd.

All Rights Reserved. No part of this publication may be reproduced, stored in a retrieval system, or transmitted, in any form or by any means, electronic, mechanical, photocopying, recording, or otherwise, without the prior written permission of Cherub Technology Co., Ltd.



Owner's manual
使用手册

WARNING

To reduce the risk of fire or electric shock, do not expose this appliance to rain or moisture.

CAUTION

This device complies with part 15 of the FCC Rules. Operation is subject to the following two conditions: (1) this device may not cause harmful interference, and (2) this device must accept any interference received, including interference that may cause undesired operation. Any changes or modifications not expressly approved by the party responsible for compliance could void the user's authority to operate the equipment.

NOTE: This equipment has been tested and found to comply with the limits for a Class B digital device, pursuant to Part 15 of the FCC Rules. These limits are designed to provide reasonable protection against harmful interference in a residential installation. This equipment generates, uses and can radiate radio frequency energy and, if not installed and used in accordance with the instructions, may cause harmful interference to radio communications. However, there is no guarantee that interference will not occur in a particular installation.

If this equipment does cause harmful interference to radio or television reception, which can be determined by turning the equipment off and on, the user is encouraged to try to correct the interference by one or more of the following measures:

- Reorient or relocate the receiving antenna.
- Increase the separation between the equipment and receiver.
- Connect the equipment into an outlet on a circuit different from that to which the receiver is connected.
- Consult the dealer or an experienced radio/TV technician for help. The device has been evaluated to meet general RF exposure requirement. The device can be used in portable exposure condition without restriction.



The lightning symbol within a triangle means, "Electrical caution!" It indicates the presence of information about operating voltage and potential risks of electrical shock.



The exclamation point within a triangle means, "Caution!" Please read the information next to all caution signs.

System Overview

The NUX B-3RC is a new generation of 2.4GHz wireless microphone system, designed for those who want to get rid of the cables and enjoy the wireless world without a complicated setup. An extra dynamic microphone is packed into the box of the bundle set.

If the environment is full of RF transmitters, sometimes B-3RC will meet interference, please keep B-3RC at least 3 meters from the Wi-Fi router.

NUX B-3RC offers various of 2.4GHz wireless systems, the units will automatically choose a channel from all 6 channels.

Please avoid using other wireless systems together with NUX ones, or there may be noise or interference issues.

Features

- Easy to use 2.4GHz wireless microphone system
- 24bit Hi-Resolution audio quality
- Ultra-low latency<4.8ms
- Auto pairing and auto channel selection
- Long-lasting built-in lithium battery(3.5 hours working time)

Transmitter

- ① Female Port
- ② Battery/Mute Indicator
- ③ Power/Mute Button
- ④ Magnetic charging contacts

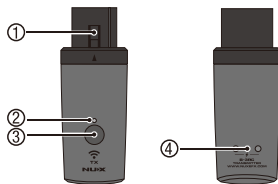

Receiver

- ① Male Port
- ② Power/Mur Indicator
- ③ Power Button
- ④ Magnetic charging contacts

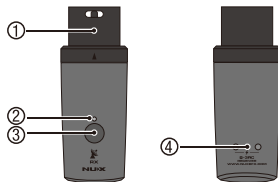

NDM-4 Dynamic Microphone

- ① Mic
- ② Switch
- ③ Transmitter Port

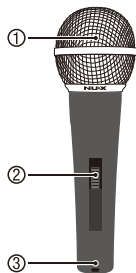

How to Operate

Transmitter and Receiver Pairing

B-3RC has auto pairing and channel group selection. Please follow the steps:

1. Turn on the Transmitter and Receiver units.

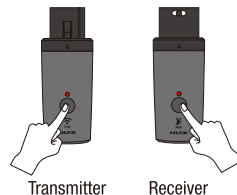

2. The Transmitter and Receiver will get paired automatically. (The device will detect current RF environment and choose the suitable Channel Group to operate while turn on.)
3. Connect the Transmitter to your dynamic microphone, and connect the Receiver to your mixer or amplifier.

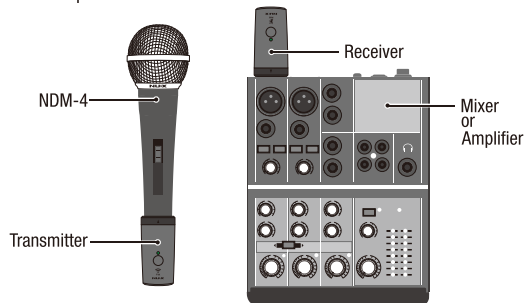

4. While you turn on the device, the power indicator(s) will show you the current battery status. The power indicator will show "GREEN" while working, if the Receiver does not get the signal, power indicator will show "RED" .

Mute Mode

While working, if you press the Transmitter's power switch button, the device will enter MUTE mode. The Transmitter and the Receiver's power indicators will show "RED" .

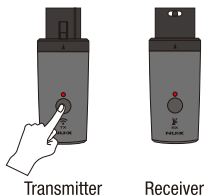

Battery status

When turning on the units, the power indicator shows the battery status:

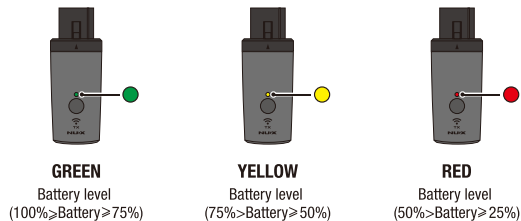

Charge

Rechargeable storage case

Charging the storage case: Connect the USB-C cable to the storage case's USB port, use 5V more than 2A adaptor to charge. It will take around 4 hours to fully charge the storage case.

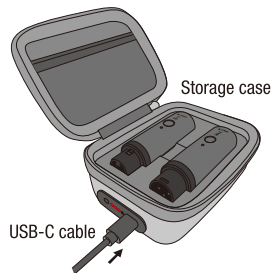

Using storage case to charge the TX & RX

While the TX & RX are in the storage case, press the storage case's power button, the storage case will start to charge both units. While charging, both units will show RED. The storage case LED indicator will turn off after 5 seconds.

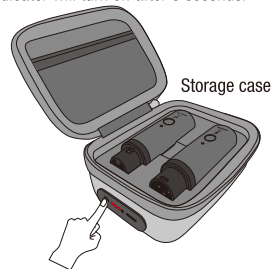

The storage case LED indicator:

Mode	SOC	LED 1	LED 2	LED 3	LED 4
Charging	<25%	Flash	Off	Off	Off
	25% - 50%	On	Flash	Off	Off
	50% - 75%	On	On	Flash	Off
	75% - 100%	On	On	On	Flash
	100%	On	On	On	On
Discharging (All off after 5s)	>75%	On	On	On	On
	50% - 75%	On	On	On	Off
	25% - 50%	On	On	Off	Off
	5% - 25%	On	Off	Off	Off
	1% - 5%	Flash	Off	Off	Off
	<1%	Off	Off	Off	Off

Auto-Off Function

The B-3RC has a built-in auto power off feature. The transmitter or receiver will automatically shut down after 10 minutes if there is no wireless connection.

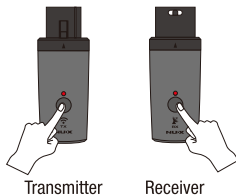

Press the power switch button to wake B-3RC up.

Application Scenarios

Wireless Recording

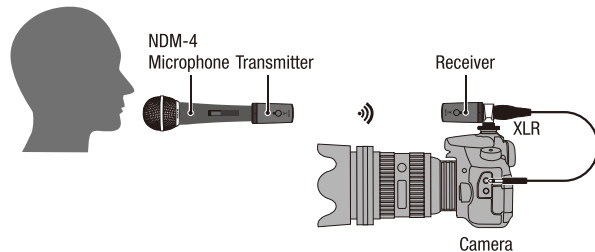

Conventional Use 1

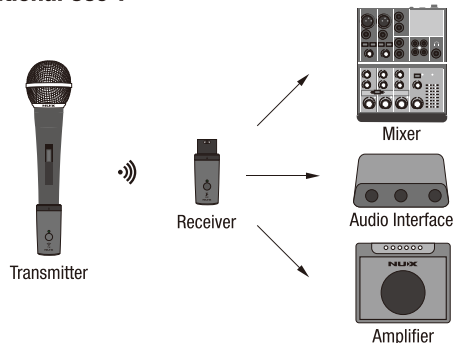

Conventional Use 2

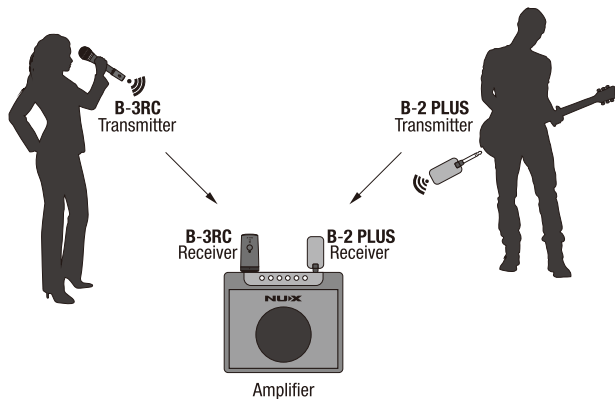

Specifications

- 2.4GHz operating frequency
- 24 bit sampling accuracy
- Latency: <4.8ms
- Transmission Range: Up to 100 feet line - of - sight
- THD + Noise < 0.1% @ 1kHz
- Built-in Battery Capacity (TX & RX): 330mAh/3.7V
- TX/RX Battery Running Time: 3.5 hours
- TX/RX Battery Charging Time: around 2.5 hours
- Storage Box Battery Capacity: 3000mAh/3.7V
- Storage Box Battery Charging Time: around 4 hours
- Dimensions
 - Transmitter: 80mm(L) x 24mm(W) x 24mm(H)
 - Receiver: 80mm(L) x 24mm(W) x 24mm(H)
- Weight
 - Transmitter: 36g
 - Receiver: 36g

*Specifications and appearance subject to change without notice.

NDM-4 Dynamic Microphone

Polar Pattern

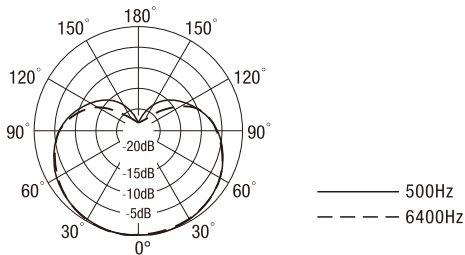

Frequency Response Curve

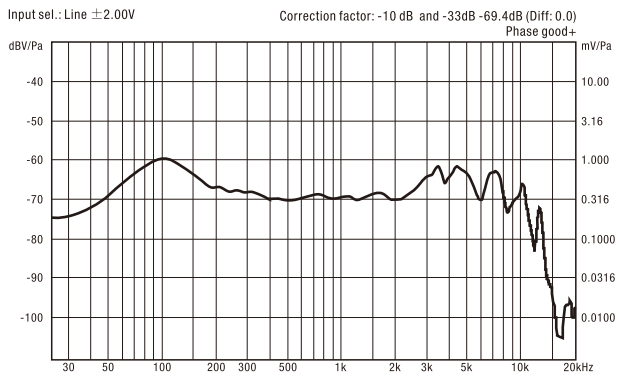

Specifications

- Type: Dynamic Type
- Impedance: $600\Omega \pm 15\%$ (AT 1kHz)
- Sensitivity: $-48.4 \pm 3dB$ ($0dB = 1v/pa$)
- Frequency Response: 50Hz - 15kHz
- Direction: Uni - Directional (Cardioid) Polar Pattern
- Operating Temperature: $-30^{\circ}C - 60^{\circ}C$
- Construction: Sponge Ref - shake Type
- Dimensions: 164mm(L) x 50mm(W) x 50mm(H)
- Weight: 213 g

*Specifications and appearance subject to change without notice.

What's in the package?

- Transmitter x 1
- Receiver x 1
- NDM-4 x 1
- Mic Pouch x 1
- Charging Cable x 1
- User Manual x 1
- Warranty card x 1

产品简介

感谢您选购NUX B-3RC，它是一款基于2.4GHz无线技术的新一代麦克风无线系统。几乎不需要任何设置，它就能将您最喜爱的动圈式麦克风变成无线麦克风，从此摆脱线材的束缚，享受无线乐趣。

为了满足乐手的需求，我们开发了多款2.4GHz无线系统产品，同一空间内最多可同时使用6对NUX无线产品。

为了避免出现噪声或串扰问题，请尽量避免将其它无线产品与NUX无线产品一起使用。

产品特点

- 即插即用2.4GHz麦克风无线系统
- 24bit高保真音质
- 小于4.8毫秒超低系统延迟
- 业界领先的自动配对系统
- 内置高性能锂电池，可持续工作约3.5小时

发射器

- ① 卡农接口（母）
- ② 电源/静音指示灯
- ③ 电源/静音按键
- ④ 磁吸充电触点

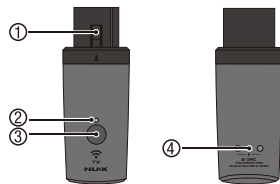

接收器

- ① 卡农接口（公）
- ② 电源/静音指示灯
- ③ 电源按键
- ④ 磁吸充电触点

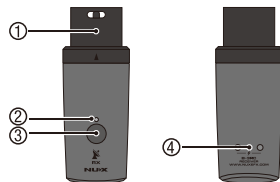

NDM-4 动圈式麦克风

- ① 麦克风网罩
- ② 电源开关
- ③ 发射器接口

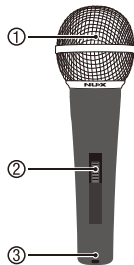

操作指南

配对与使用

B-3RC内置了强大的自动配对功能，请按照如下步骤操作：

1. 按住发射器、接收器的电源按键直至开机。

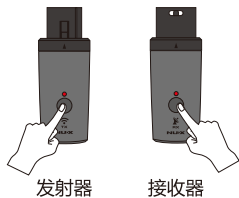

2. 发射器与接收器会开始检测射频环境并自动选择最佳的工作通道完成配对。
3. 将发射器连接至您的动圈式麦克风，将接收器连接到您的调音台或音箱。

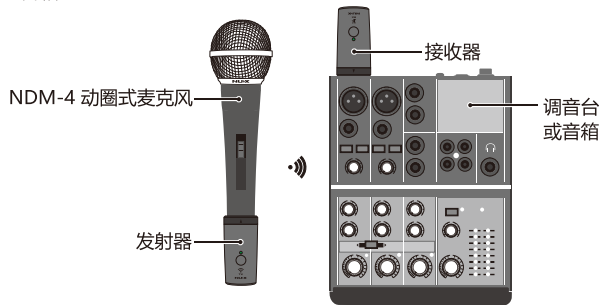

静音模式

B-3RC正常工作时按发射器的电源按键一次可以进入“静音模式”，发射器与接收器的工作指示灯均会长亮红色。在静音模式下再按一次发射器上的电源按键便可以使B-3RC恢复到正常工作模式。



电池状态

当打开机器时，指示灯会显示电量信息，指示灯不同颜色所表示的电量信息如下：

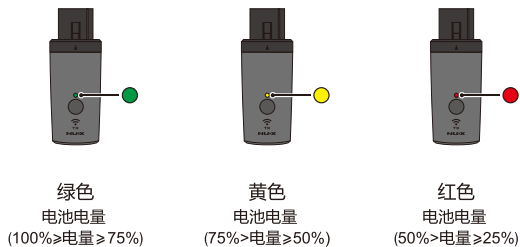

充电

给充电收纳盒充电

请使用5V输出电流至少为2A的充电器为充电收纳盒充电，低电量到满电状态充电时间约为4小时。



使用充电收纳盒为发射器与接收器充电

将发射器与接收器关机并放入充电收纳盒，然后按充电收纳盒上的充电按键激活充电功能。

开始充电时，充电收纳盒上的电量指示灯会亮起5秒后自动熄灭。发射器与接收器充电时，机身的指示灯会呈红色常亮状态，充满电后指示灯会自动熄灭。

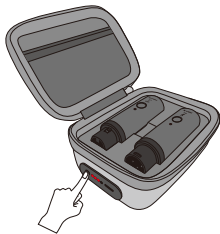

查看充电收纳盒电量

您可以依据下表查看充电收纳盒在充放电时的电量：

模式	电量	LED 1	LED 2	LED 3	LED 4
充电模式	<25%	闪烁	熄灭	熄灭	熄灭
	25% - 50%	长亮	闪烁	熄灭	熄灭
	50% - 75%	长亮	长亮	闪烁	熄灭
	75% - 100%	长亮	长亮	长亮	闪烁
	100%	长亮	长亮	长亮	长亮
放电模式 (5秒钟后全部熄灭)	>75%	长亮	长亮	长亮	长亮
	50% - 75%	长亮	长亮	长亮	熄灭
	25% - 50%	长亮	长亮	熄灭	熄灭
	5% - 25%	长亮	熄灭	熄灭	熄灭
	1% - 5%	闪烁	熄灭	熄灭	熄灭
	<1%	熄灭	熄灭	熄灭	熄灭

自动关机功能

为了最大限度延长电池续航时间，B-3RC内置了自动关机功能。发射器或接收器在无线没有连接时，10分钟后将自动关机。再次使用时需按电源按键重新开机。

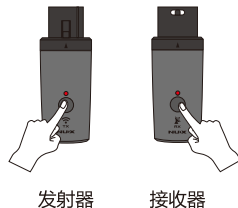

发射器

接收器

使用场景

无线录音

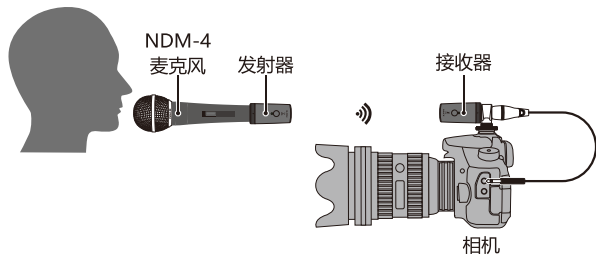

常规用途一

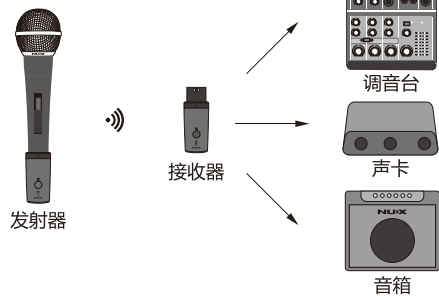

常规用途二

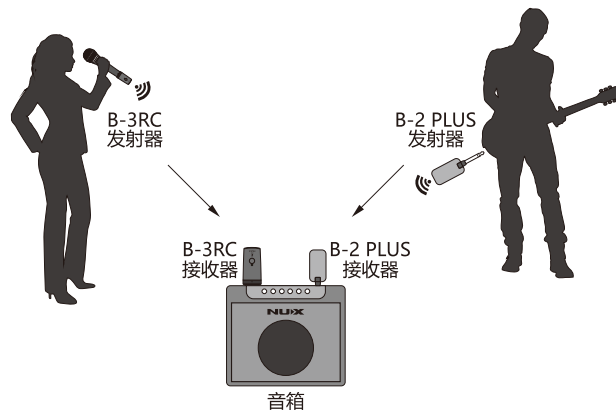

技术规格

- 工作频率: 2.4GHz
- 采样精度: 24bit
- 系统延时: <4.8ms
- 有效距离: ≤30m (实际距离会因使用环境而异)
- 信号失真度: <0.1% @ 1kHz
- 内置锂电池容量 (发射器/接收器): 330mAh/3.7V
- 发射器/接收器工作时间: 3.5小时
- 发射器/接收器充电时间: 大约2.5小时
- 充电收纳盒内置锂电池容量: 3000mAh/3.7V
- 充电收纳盒充电时间: 大约4小时
- 体积
发射器: 80mm(L) x 24mm(W) x 24mm(H)
接收器: 80mm(L) x 24mm(W) x 24mm(H)
- 重量
发射器: 36g
接收器: 36g

*技术规格如有变更, 恕不另行通知。

NDM-4 动圈式麦克风

指向性图

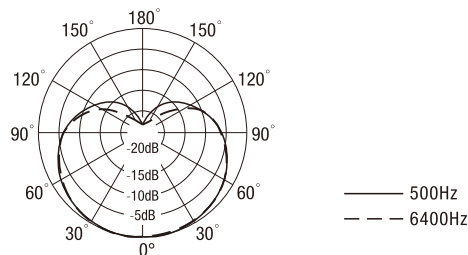

频响曲线

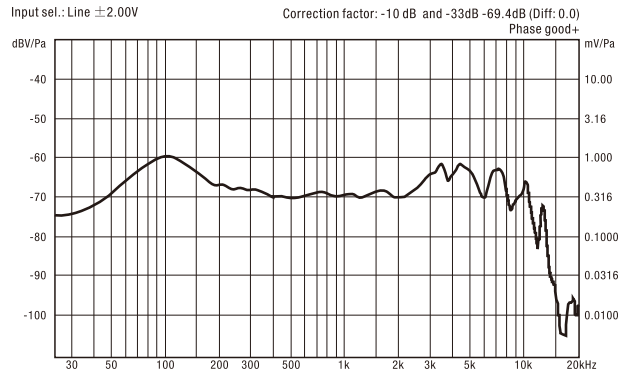

技术规格

- 型式：动圈式
- 标准阻抗：600Ω ± 15% (AT 1kHz)
- 正面灵敏度：-48.4 ± 3dB (0dB = 1v/pa)
- 频率响应范围：50Hz - 15kHz
- 指向特性：单一指向
- 工作温度范围：-30°C - 60°C
- 结构：阻尼避震式
- 体积：164mm(L) x 50mm(W) x 50mm(H)
- 重量：261g

包装内含

- 发射器 x 1
- 接收器 x 1
- NDM-4 x 1
- 麦克风支架 x 1
- 充电线 x 1
- 使用手册 x 1
- 保修卡 x 1

*技术规格如有变更，恕不另行通知。

有关产品中所含有害物质限量的说明

为了控制和减少电器电子产品废弃后对环境造成的污染，本资料就本公司产品中所含的特定有害物质限量及其安全性予以说明。

本资料适用于2022年12月31号以后本公司所制造的产品。

环保使用期限



此标志适用于在中国国内销售的电子信息产品，表示环保使用期限的年数。所谓环保使用期限是指在制造日起的规定期限内，产品中所含的有害物质不致引起环境污染，不会对人身、财产造成严重的不良影响。环保使用期限仅在遵照产品使用说明，正确使用产品的条件下才有效。不当的使用，将会导致有害物质泄漏的危险。

产品中所含有害物质限量说明

项目	限量	
	A类	B类
邻苯二甲酸酯类物质的限量	○	○
多环芳烃类物质的限量	○	○
可迁移元素物质的限量	○	○
苯系物、总挥发有机化合物及甲醛物质的限量	○	
五氯苯酚 (PCP) 物质的限量	○	
电子部件限用物质的限量	○	
天然放射性核素的限量	○	

*上表当中的信息依据GB 28489-2022仅在产品含有其中限量要求项目时适用。

本表格依据GB 28489-2022的规定编制。

○表示该有害物质在该部件所有均质材料中的含量均在GB 28489-2022第五章规定的限量要求以下。

保护环境

如果需要废弃本产品，请遵循本地相关指引，请勿随意丢弃或作为生活垃圾处理，以避免对环境造成污染。

质量承诺

亲爱的NUXX用户：

在您使用NUXX产品时，请仔细参阅产品说明书，当您有疑问和困难时，请拨打售后服务热线：
400-990-9866

- 一周内出现质量问题可退货退款
- 一年内出现质量问题可免费维修
- 一月内出现质量问题可调换
- 终身享有咨询和维修服务

[请向销售商索取正规发票并予以保存]

换修政策

一、包换政策：

- 1、消费者通过正规授权渠道购买的产品，自购机之日起1个月之内，在正常使用情况下出现非人为的产品性能故障、且产品外观及包装保持完好，可向所购机的经销商换机。
- 2、消费者在换机时应出示由经销商开出的购机凭证，否则经销商可以不予更换。

二、保修政策：

- 1、消费者通过正规授权渠道购买的产品(以发票所示销售方为准)，自购买之日起1年内，若出现非人为损坏的性能故障，可享受免费维修服务。
- 2、对于超过1年或人为及不可抗力因素造成损坏的产品，我司可提供有偿维修服务。

*本售后政策仅适用于中国大陆地区，其它国家及地区以当地售后政策及法律法规为准。

售后服务地址

广东省珠海市高新区唐家湾镇科技九路10号 邮编:519080
珠海市蔚科科技开发有限公司 售后服务部

制造商: 珠海市蔚科科技开发有限公司 生产商: 珠海市蔚科科技开发有限公司
地址: 珠海市高新区唐家湾镇科技九路10号 电话: 0756-3689 866 网址: cn.nuxaudio.com

合格证 Certificate

检验员
Inspector

生产日期
Date

名称
Name

型号
Type

麦克风无线系统

B-3RC

本产品经检验合格
This product is inspected and approved.

执行标准: Q/WKDDZ 001-2020
Product is certified with Q/WKDDZ 001-2020